

Audio-Video Selector

For presentation media



Audio-Video Selector



FEATURES

- ▶ system for 2 participants at good value
- ▶ indication of selected unit by illuminated push-button
- ▶ key lock against unintentional pressing of the button
- ▶ automatic signal detection
- ▶ easy installation by coded connectors (plug & play)
- ▶ easy mounting by screw fixing
- ▶ compatible to all NETBOX-types



Connectors Audio-Video Selector

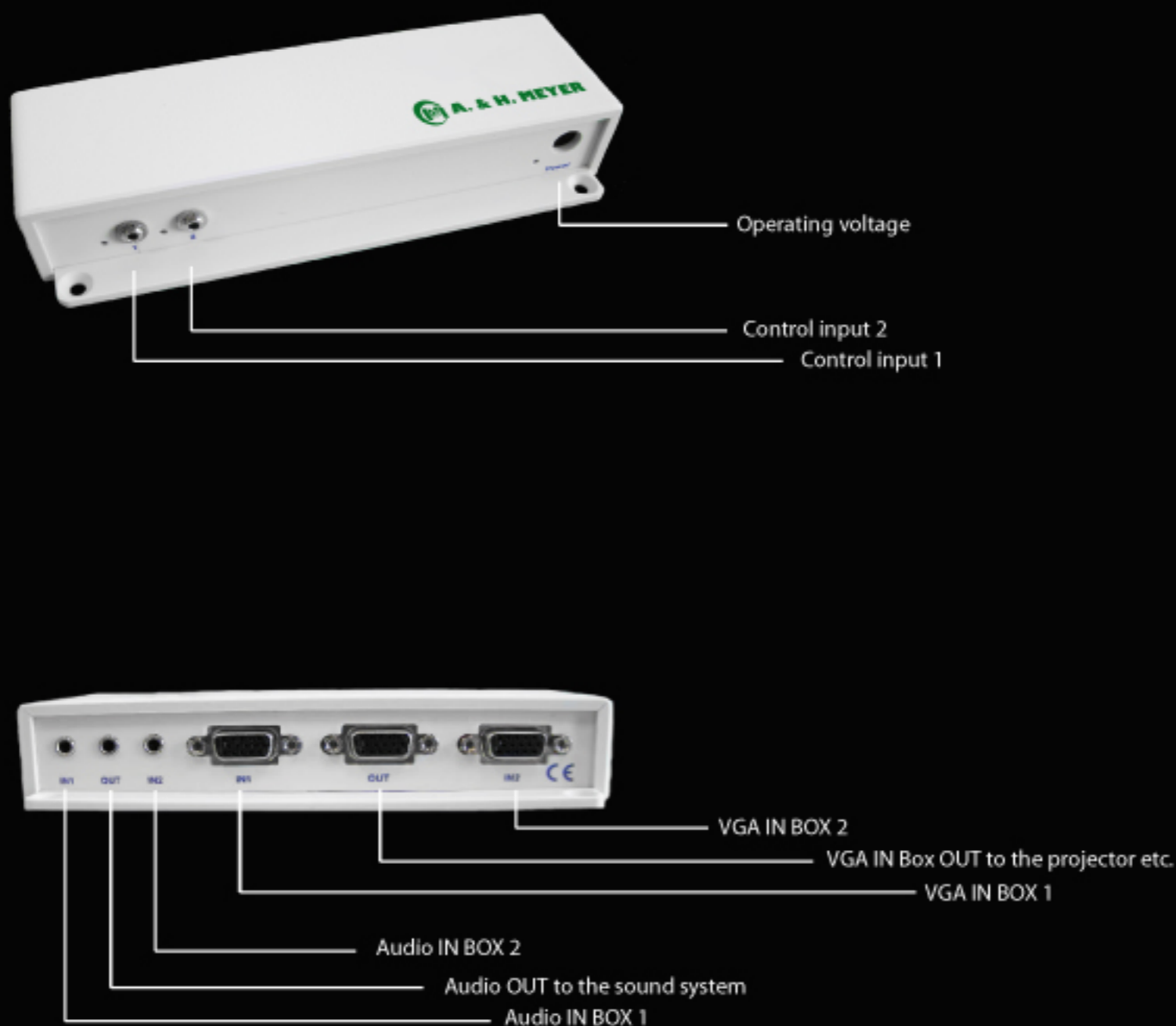

Audio-Video Selector



Connection scheme

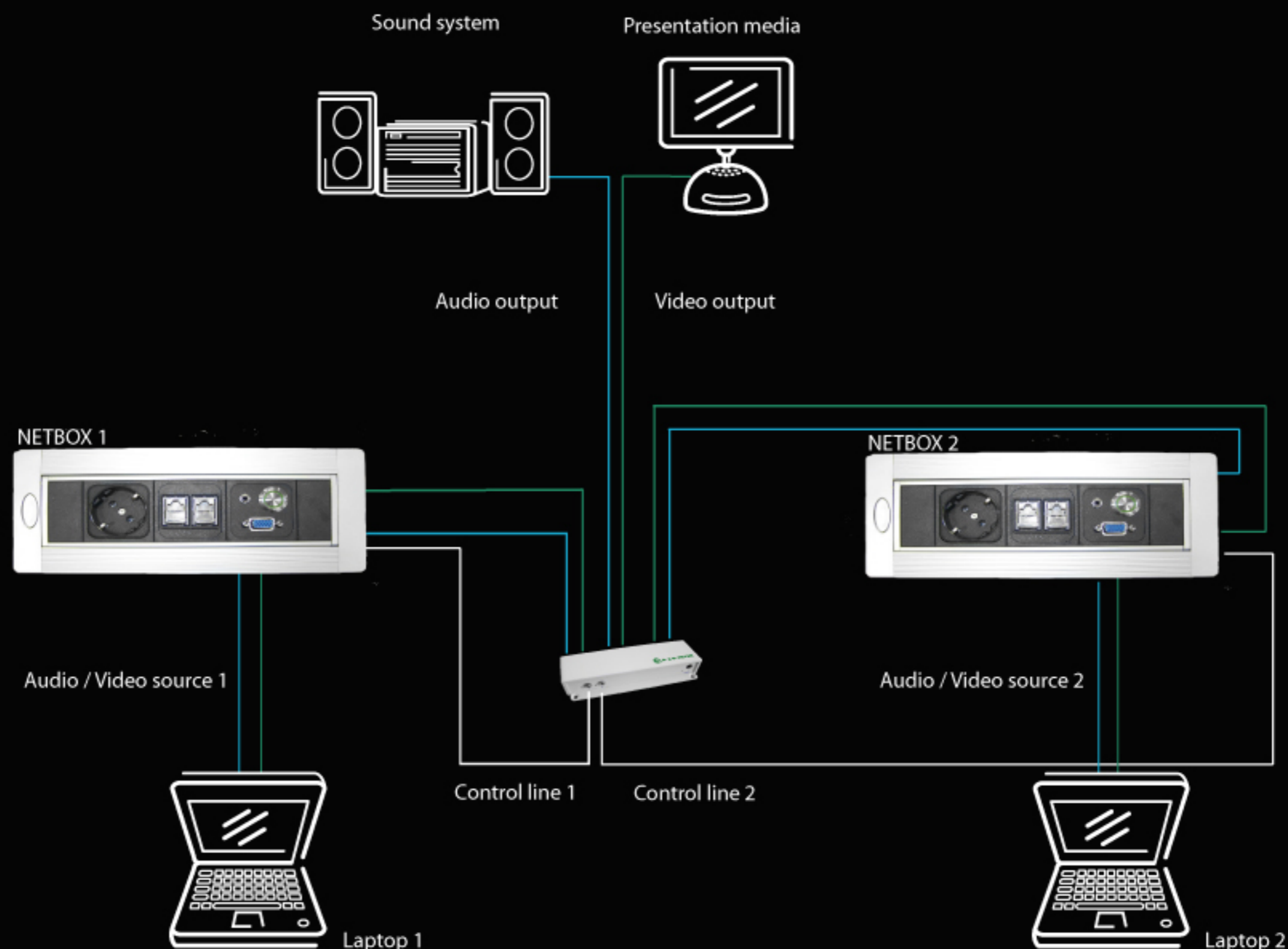

Technical data:

Plug and Play: Auto Detect

Operating voltage: 7,5V DC

Video input signals: 0,7Vss / 75 Ohm RGB

Video output signals: 0,7Vss / 75 Ohm RGB

Video bandwidth: (+/- 3db) 250 MHz

Resolution max.: 1600 x 1200

H/V Sync.: 250 kHz / 520 Hz

Audio: Stereo L / R

Connections: 3 x 15pol. HD socket / 3 x 3,5mm stereo audio jack
2 x 2,5mm jack

Weight: 145g

Dimensions W/H/D: 158 x 29 x 69 mms

